



ITALY SCOTTI 4/5 AXIS TAIWAN DEALER



INDIA PRAGATI TURRET SALES & MAINTENANCE



CHEN SHIN MACHINERY CO., LTD.

BUSINESS

OIL MIST COLLECTOR
OIL MIST COLLECTOR SYSTEM
POWER TOOL

ITALY IMPORTED 4/5 AXIS INDEX TABLE
ITALY IMPORTED LIVE CENTER
INDIA IMPORTED SERVO & POWER TURRET

Oil mist collector system
intergration profesesionist

Headquater

Chen Shin (TCSM) MC., Ltd.
TEL: +886-47-331657 、 +886-47-331659
FAX: +886-47-330116
ADD:No.30, Aly. 63, Ln. 446, Sec. 2, Zhangmei Rd.,
Hemei Township, Changhua County 50848, Taiwan (R.O.C.)
WEB:www.tcsm.com.tw



WEBSITE

Southern Taiwan Dealer

Tengyu Company
TEL: +886-6-3020662
FAX: +886-6-2044829
ADD:No.23, Aly. 32, Ln. 316, Zhongshan S. Rd.,
Yongkang Dist., Tainan City 71075, Taiwan (R.O.C.)



FACE BOOK



Technology Concern Service Multiplicity

CS series physical theory oil mist collector

Patented cyclone design allows 90% oil mist to be solidified as oil drop through physical dash theory for first cutting liquid recycle. Then the small oil drops will be brought upward to the filter kit for filtration and second recycle to ensure the max. recycle and reuse ability .

High efficiency

Patented cyclone creates huge wind flow, and centrifuge filtration reduce the saturated rate of filter kit.

Special filtration system

High density filter kit, each cubic millimeter is crisscross by 100 small holes

Energy saving

Using high efficiency motor to save the energy consumption.

Low vibration

Multiple balance calibrate, separate the filter kit from fan, to ensure the balance of fan after a long term usage.

Chooseable Installation

Position choosing depends on the factory layout and not to interfere the working flow.

Specification

Model	Size mm		Inlet dia. mm	Air rate m ³ /hr	Oil pipe dia. Mm	Fix position on machine mm			Weight kg	Motor kw
	A	B				G	D	E		
CS-900 MKI	φ380	320	125	900	OD 25	150	PCD 280	4-φ10	27	0.37
CS-900 MKII	φ380	320	125	900	OD 25	150	PCD 280	4-φ10	27	0.37
CS-900 PLUS	380x380	350	125	950	OD 32	150	PCD 280	4-φ10	29	0.37
CS-1200 MKIII	420x420	500	125	1200	OD 35	150	PCD 280	4-φ10	44	0.37
CS-2000 MKIV	500x500	510	150	2000	OD 35	170	PCD 280	4-φ10	68	0.75
CS-3000 MKV	530x530	600	200	3000	OD 35	220	PCD 320	6-φ10	78	1.50

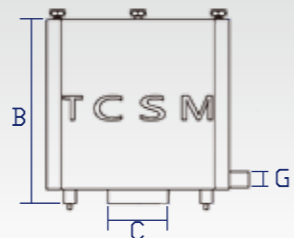
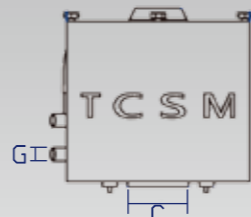
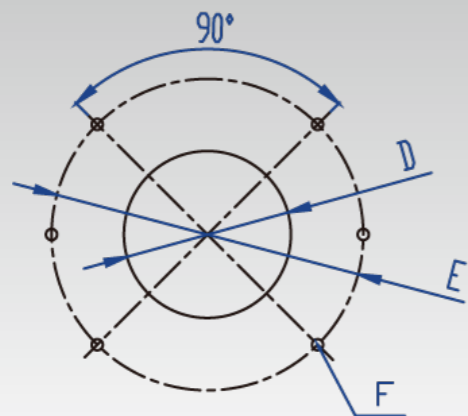
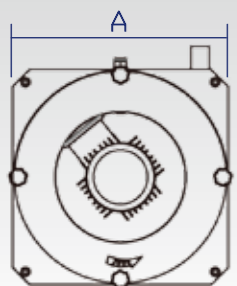
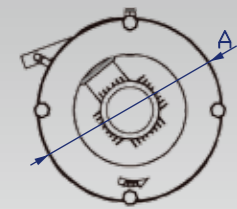

Post Electrical Oil Mist Collector — for eliminate filtrated fuggy

After the oil mist was filtrated, the discharged fuggy can be eliminated by the electrical oil mist collector by using the electrical absorbe theory to eliminate the small fuggy to allow the filtered air can be exhasusted indoor.

No comsuption material

Electrical board can be reused after wash

Replace the post filtration.



Electrical Oil Mist Collector — working theory

Using static electrical dust collector theory, the Electrical oil mist collector with four stage layers to carry out the filtration. First net layer blocks the bigger oil drop then the second high pressure electrical feild make the small oil drop attached with positive charge. The third nagtive electrical plate will adsorb the oil drops. The last the smell will be adsorbed at last active carbon layer to allow the air can be directly exhusted in the working plate.

Non-Smoke dust collector — collecting the dust on the work piece

The dust on the work piece can be collected in the bocket by using big wind to sock downward for easily cleaning and recycle. And the smoke occured during cleaning can be filtered by the post filtration box to ensure the clearance of working place.

Efficiently recycle the dust on the workpiece:

The dust can be well collected for easily dust recycle.

Ensure a cleaning working environment:

The workpiece been cleaned in a half-closed space to prevent the dust spread.

None-smoke spread:

The oil mist will be collected to the top of the dust collector and been filtered by the filtration facility to ensure the smoke is eliminated.

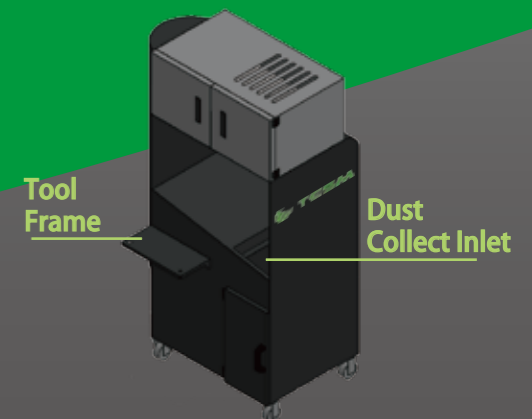
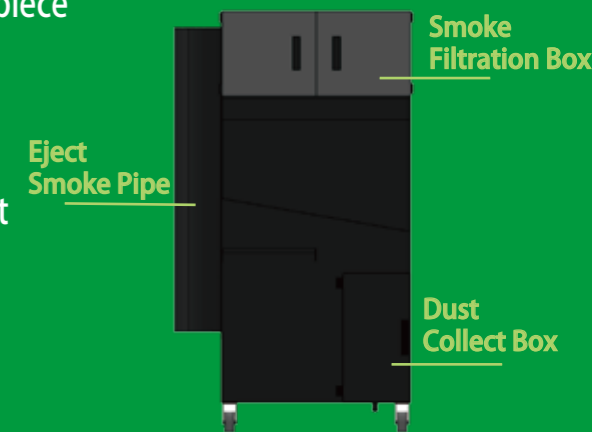

CE series - Electrical oil mist collector

With four stage filtration layers to carry out the filtration. First net layer blocks the bigger oil drop for first recycle. The partical with positive charge when go through second electrical plate and being collect at third negative electrical plate for second recycle. At last been filtrated by filter kit.

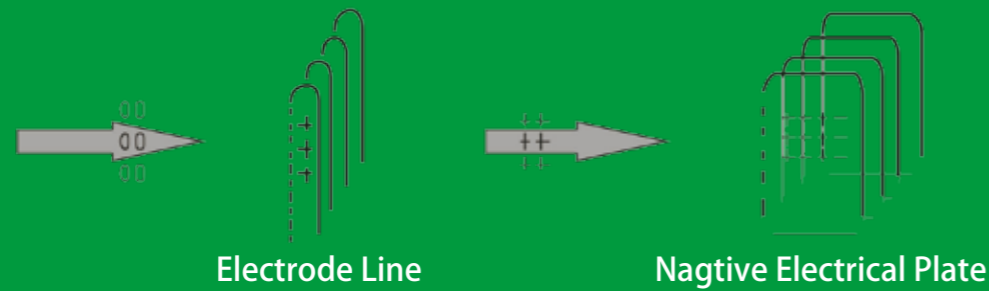

Multy filtration

Four filtration layers including statical electrical adsorb layer to achieve the best filtration result, the filtration rate reaches 99.95%

Low consumption

The plate is saturated the dust collecting efficiency redused. Can be re-used after cleaning to reduce the cost on consupcion part.

Stable quality

Using high stainless material and imported spares to ensure the stability of quality.

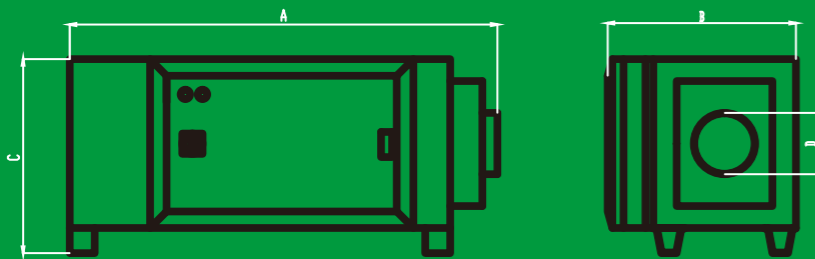

Model	Size mm			Inlet Dia. mm	Air Flow m ³ /hr	Pipe Dia. mm	Weight kgs	Motor kw
	A	B	C					
CE-900	925	610	620	φ196	900-1000	21	70	0.125
CE-1800	1368	610	620	φ196	1800-2400	21	101	0.420

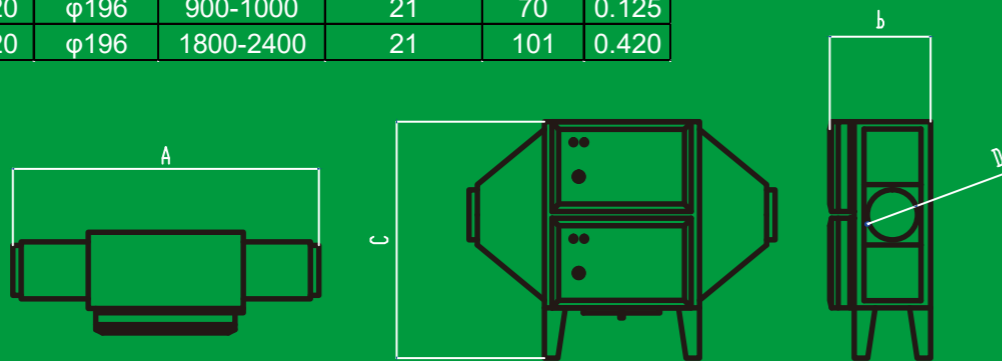

Model	Size mm			Inlet Dia. mm	Air Flow m ³ /hr	Pipe Dia. mm	Weight kgs	Motor kw
	A	B	C					
CE-4000	1825	610	1440	φ300	4000-6000	21	180	*
CE-8000	1825	1078	1440	φ600	8000-10000	21	340	*

*EXTRA FAN REQUIRED, THE POWER OF MOTOR DEPENDS ON THE USED FAN.

Patented flow field

(C) F8 High Efficiency filtration - The exhaust direction after filtration

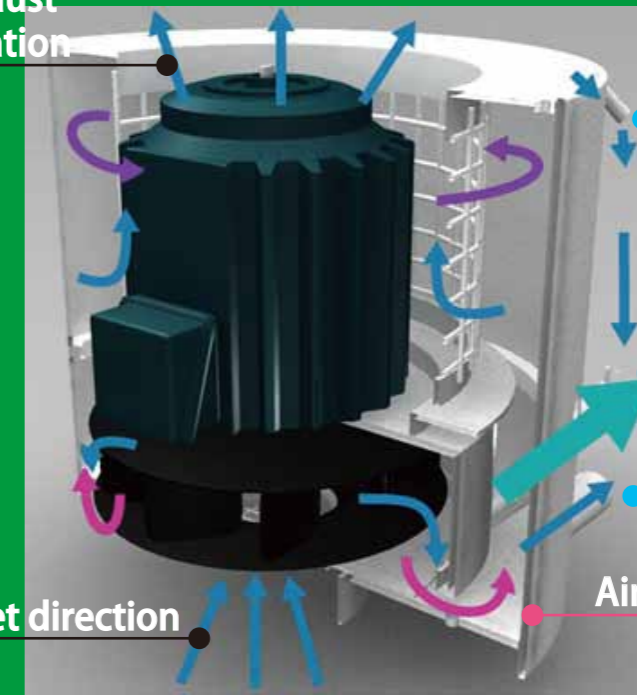

(A) Oil mist inlet direction

Air flow direction

Flow field for series CS-900

(A) Oil mist inlet direction : to sock the oil mist occured during machining process. And through the high speed centrifuge in the wheel to complAete the first recycle.

(B) Oil recycle direction :
 Second stag—as the air easily been turning than liquid, the tiny oil drop in the air will flow along the surface to the second stage for recycling.
 Third stage—the fine oil drop will along with the surface to the top of the bucket and flow out from third stage.

(C) Exhaust direction : the fine oil mist will be exhausted after filtrated by three layers high efficiency filter kit.

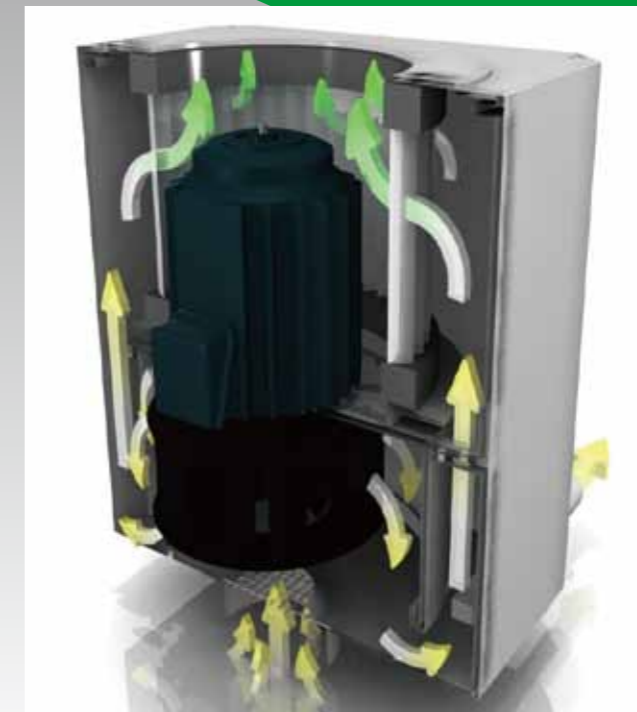

Flow field for series above CS-1200

Accessories and Layout

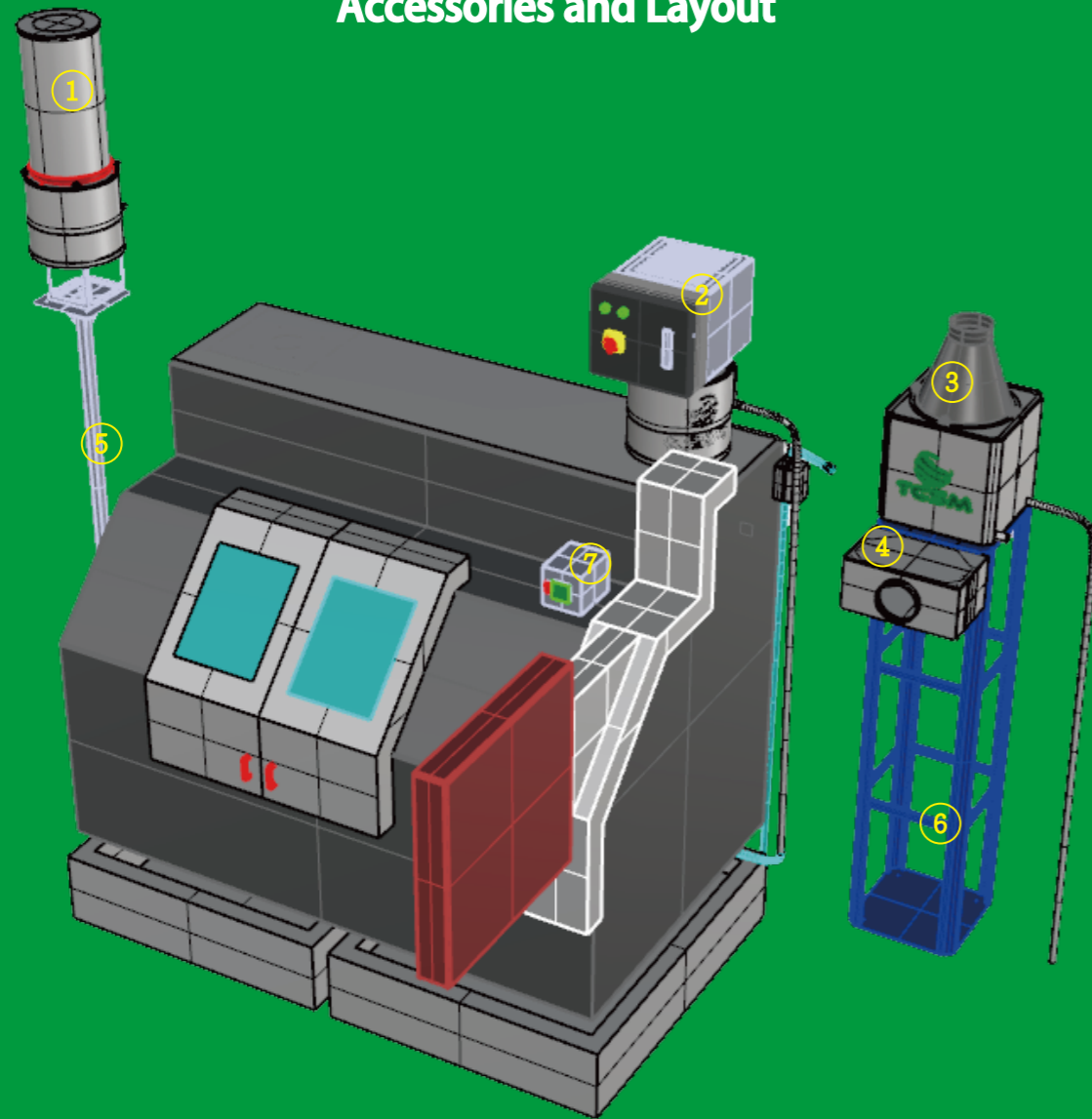

① Post filtration bucket
 Added at rear of collector for smoke filtration
 Capacity: $>1 \mu\text{m}$ partical
 Life cycle: 6000 working hours

② Post static electrical processor
 Added at rear of collector for smoke filtration
 Capacity: $>1 \mu\text{m}$ partical
 Life cycle: reuseable after cleaned

③ Post exhausted hood
 For whole plant piping when needed to exhaust the smoke out or other post process.

④ Pre - oil blocker
 For the machine with volume oil, add before the collector to stop the oil by physical theory.

⑤ Stand
⑥ For the machine without enough space for installation or the thickness of metal is not strong enough.

⑦ Patented temperature switch
 To monitor the temperature in the cabinet with multi-steps alarm setting to ensure "the safty of machine and factory"

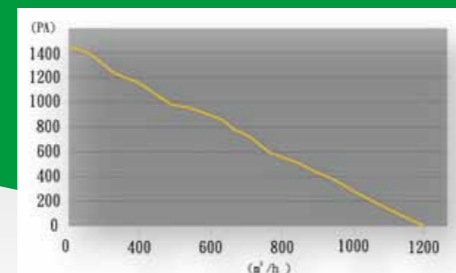
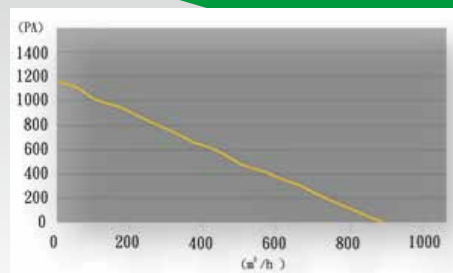

Application

Dirctly installation 1.
 Install on the machine directly



Dirctly installation 2.
 Add the post exhaust hood for piping.



Dirctly installation 3.
 Add the post filtration bucket to exhaust the air directly in the workshop.



None directly installation 1.
 Directly install on the machine with a frame.



Comsuption replacement

Non-woven fabric filtration kit
 Able to filter the partical over $5 \mu\text{m}$.

Polyeste drainage layer
 Able to filter the partical above $50 \mu\text{m}$.



Polyeste filtration layer
 Olephilic, able to filter the partical between $15-20 \mu\text{m}$.